



Absolute Maximum Ratings at Ta=25

| Parameter | MAX. | Unit |
|---------------------------|------|------|
| Power Dissipation | 100 | mW |
| Collector-Emitter Voltage | 30 | V |
| Emitter-Collector Voltage | 5 | V |
| Collector Current | 50 | mA |

Moisture Sensitivity Level^{*1}

4

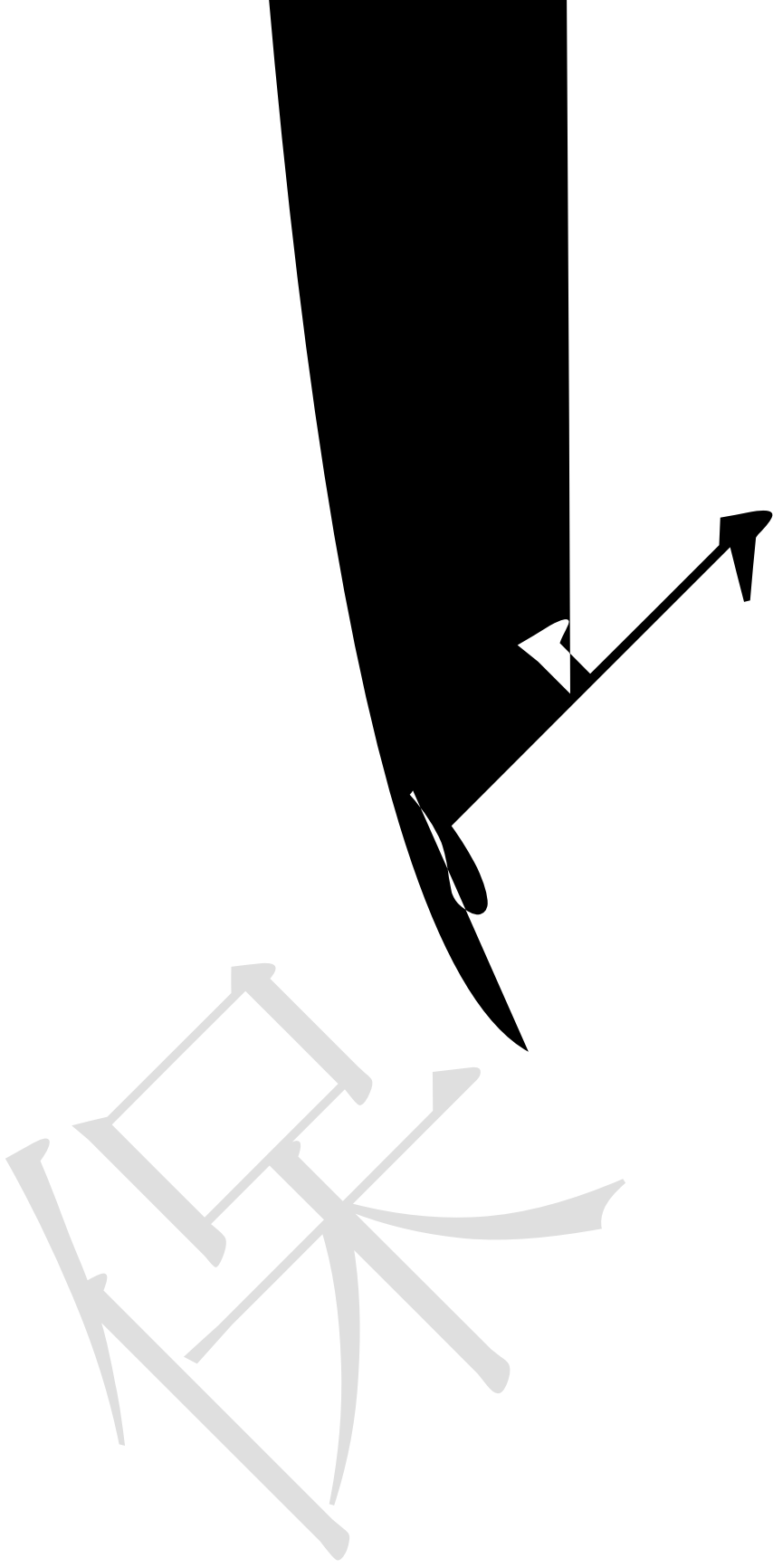

Typical Electrical / Optical Characteristics Curves (25 Ambient Temperature Unless Otherwise Noted)

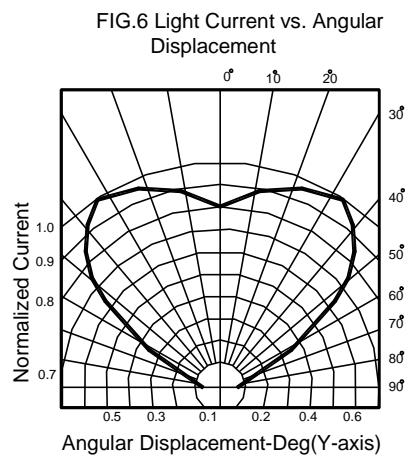
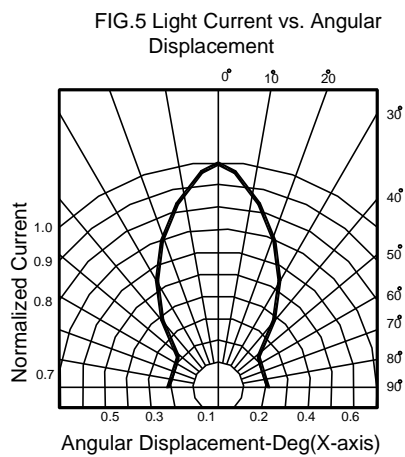
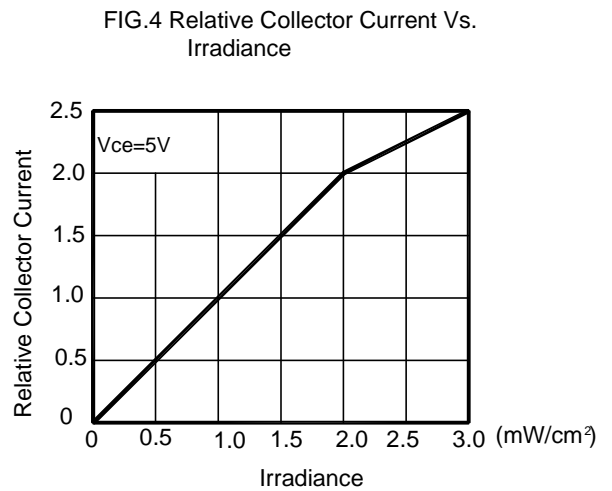
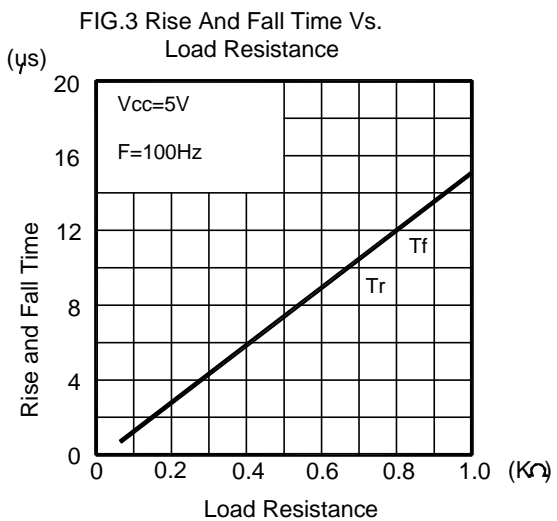
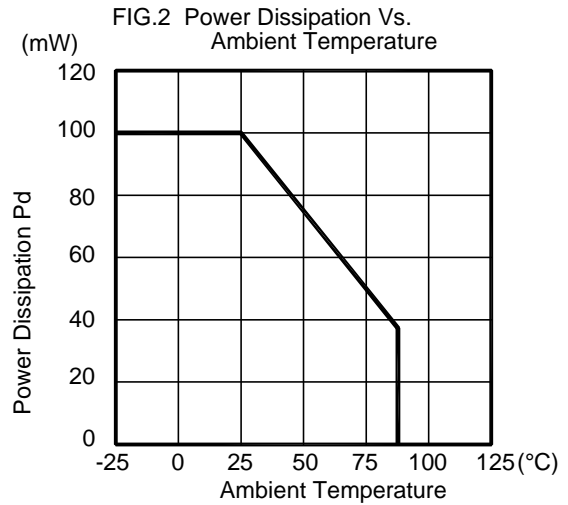
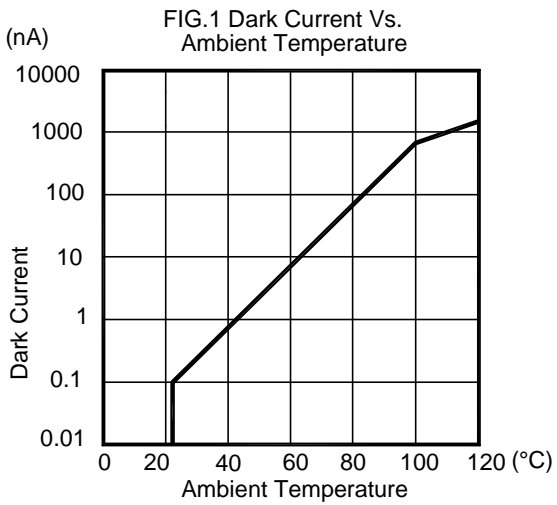

LIGHT

LIGHT ELECTRONICS CO., LTD.

Part No. SL-T3010PTB020-L200-Q

D

Label Explanation

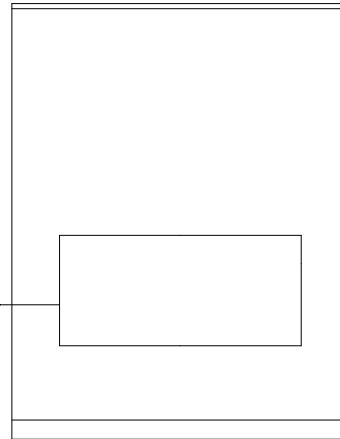

Bag

| | |
|-----------|------------|
| TYPE NO./ | QUANTITY/ |
| BIN./ | DATE CODE/ |
| REMARKS/ | LOT NO./ |

Reel Dimensions

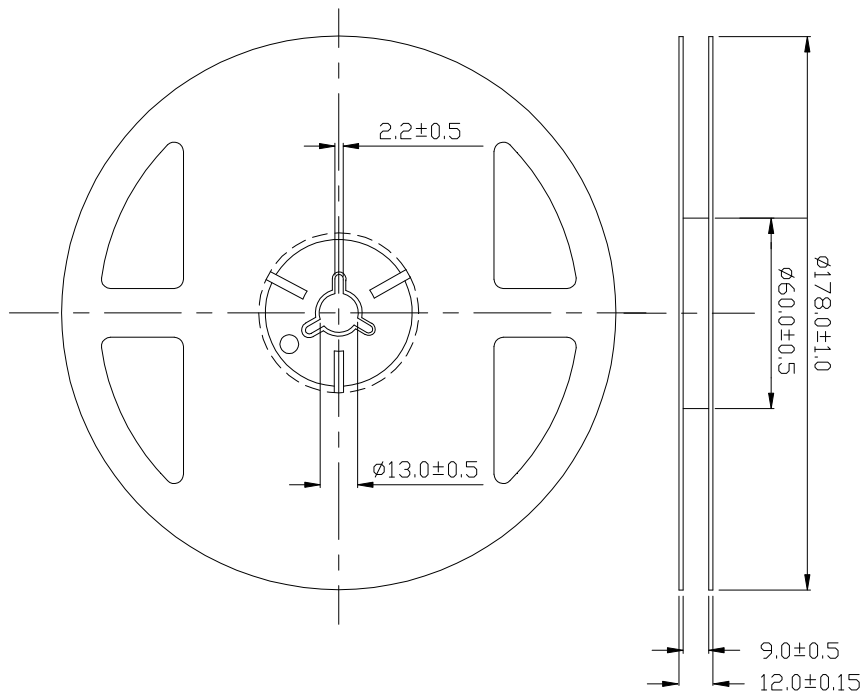

Note: Tolerance unless mentioned is $\pm 0.2\text{mm}$; Unit = mm

Suggest IR Reflow Condition For Lead Free

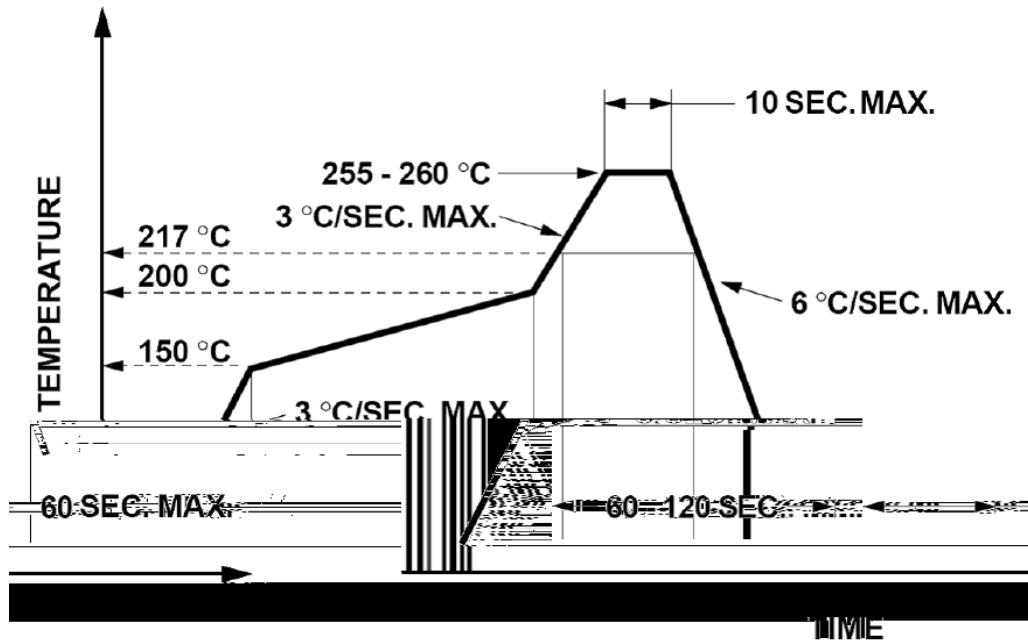

1. Reflow soldering should not be done more than two times.
2. When soldering, do not put stress on the LEDs during heating.

Soldering iron

1. When hand soldering, the temperature of the iron must less than 350 °C for 3 seconds.
2. The hand solder should be done only once.

Repairing

Repair should not be done after the LEDs have been soldered. When repairing is unavoidable, a double-head soldering iron should be used (as below figure). It should be confirmed beforehand whether the characteristics of LEDs will or will not be damaged by repairing.

